

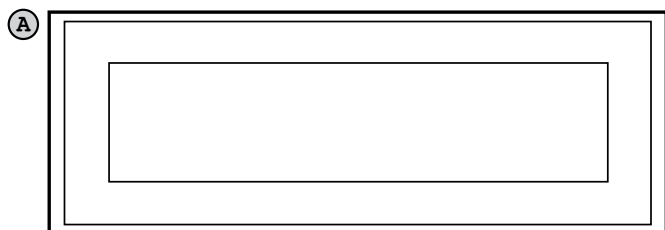

What's in the Box

Apache Face



Shafts

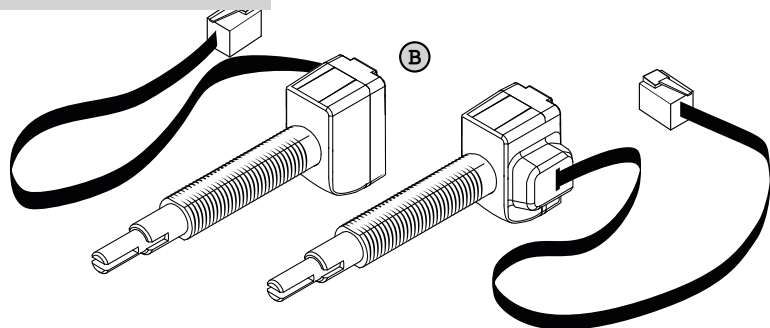

Hardware

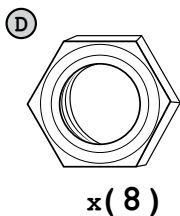
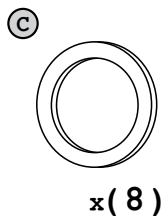

Face Screws

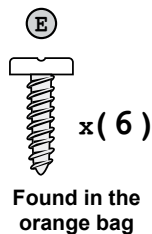

NOTE: Front and rear knobs are packaged separately.

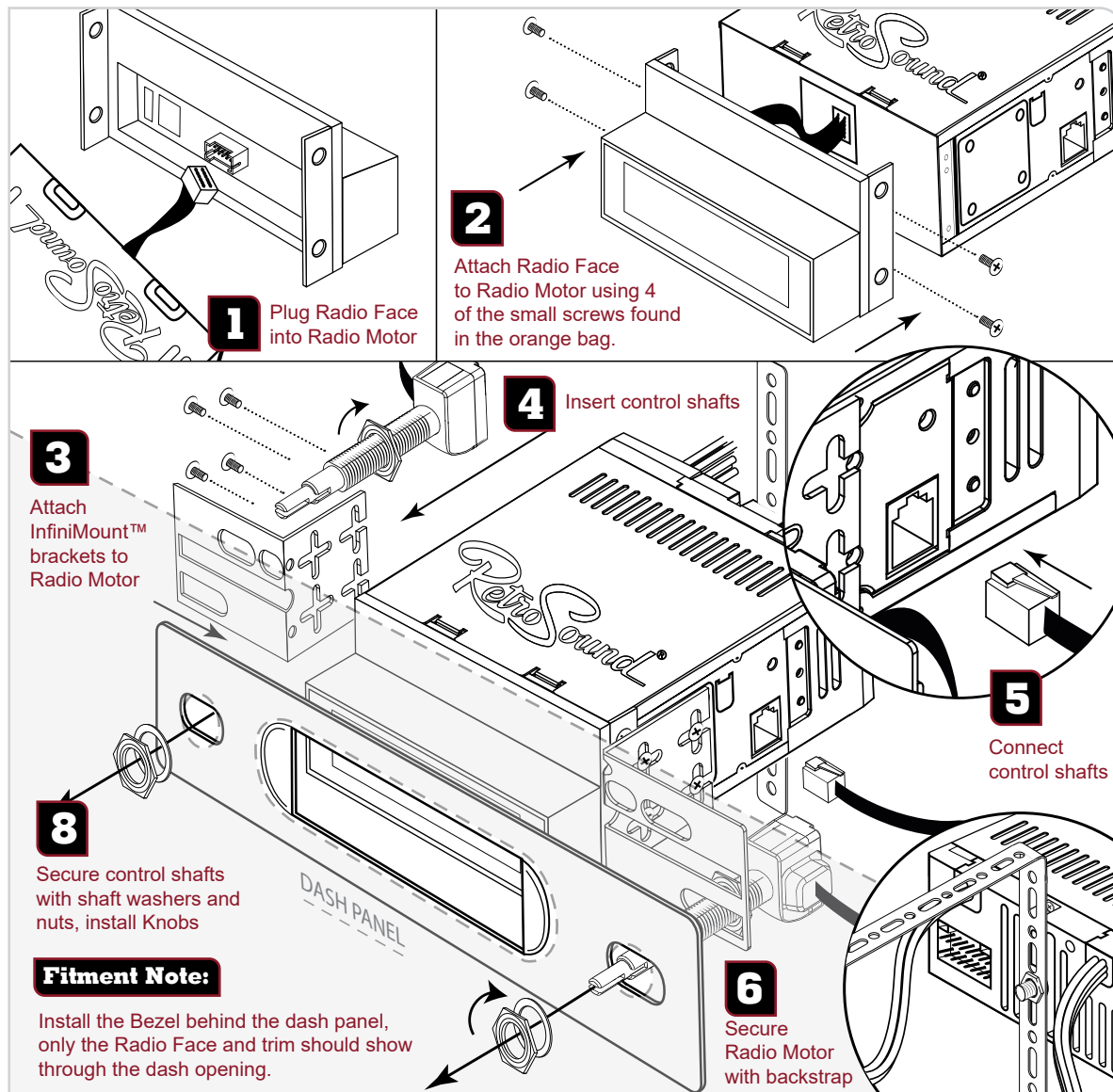

Refer to the installation manual in the Radio Motor box or on our website for more detailed instructions.



Control Layout

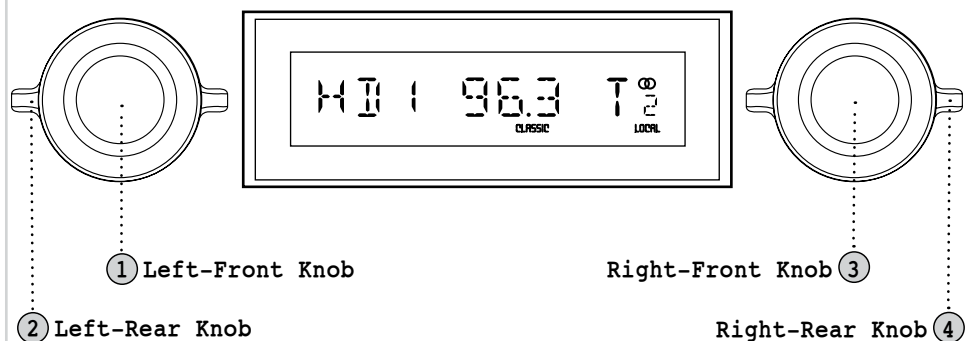

Apache Mode

IMPORTANT FIRST STEP: Setting the radio's control mode.

The following steps must be performed to set up the Radio Motor to function with the Apache Radio Face. With the vehicle's ignition on, press the Left-Front Knob(1) to turn the radio on. Press and hold the Right-Front Knob(3) for 3 seconds to access the sub-menu. Rotate the Right-Front Knob(3) to cycle through the choices until **SEL PANEL** appears then press the Right-Front Knob(3) to select. Rotate the Right-Front Knob(3) until **APACHE** is displayed on the screen. Let the unit time out to set. Your Radio Motor is now configured to work with the Apache Radio Face.

Resetting SEL PANEL: If the incorrect option is selected reset your radio's control mode. Press and hold the Left-Front Knob(1) for approximately 15 seconds. The radio will reboot into **SEL PANEL** mode. Press and release the Left-Front Knob(1) until **APACHE** appears on the screen. Let the unit time out to set.

Radio Presets

Setting Radio Presets

To store a preset on the Apache Radio Face, rotate the Right-Front Knob(3) to tune to the desired station, then rotate the Right-Rear Knob(4) clockwise to select the desired preset (1-6). Once selected, press the Right-Front Knob(3) to store.

Recalling Radio Presets

To recall a preset, turn the Right-Rear Knob(4) clockwise and release. Repeat to move through the saved presets.

Basic Operation

Power On/Off

Press the Left-Front Knob(1) to power the unit on.
Press and hold the Left-Front Knob(1) to power the unit off.

Volume

Rotate the Left-Front Knob(1) to change the volume.

Changing Source Modes

Rotate the Left-Rear Knob(2) clockwise to cycle through the source modes.

Changing Radio Bands

Rotate the Right-Rear Knob(4) counter-clockwise to cycle through the radio bands.

Tune

Rotate the Right-Front Knob(3) to scroll through the stations.

Mute On/Off

Press the Right-Front Knob(3) to mute and unmute.

Equalizer (EQ)

Press the Left-Front Knob(1) to enter the Tone Control sub-menu. Press and release the Left-Front Knob(1) until you see the EQ setting you'd like to adjust. Rotate the Left-Front Knob(1) to adjust the setting. Press the Left-Front Knob(1) to move to the next item, and repeat to adjust each option. Let the unit time out to set.

Setting the Clock

Press and hold the Right-Front Knob(3) to enter the System Settings sub-menu. Rotate the Right-Front Knob(3) to cycle through the choices until you see CLK, then press the Right-Front Knob(3) to select. Rotate the Right-Front Knob(3) to adjust the hours. Then press the Right-Front Knob(3) again to move on to minutes. Rotate the Right-Front Knob(3) to adjust the minutes. Let the unit time out to set.

Display Color*

Press and hold the Right-Front Knob(3) to enter the System Settings sub-menu. Rotate the Right-Front Knob(3) to cycle through the choices until you see SCAN, then press the Right-Front Knob(3) to cycle through the colors. Let the unit time out to set.

Beep On/Off

Press and hold the Right-Front Knob(3) to enter the System Settings sub-menu. Rotate the Right-Front Knob(3) to cycle through the choices until you see BEEP ON/OFF, then press the Right-Front Knob(3) to choose between BEEP ON or BEEP OFF.

*Some features are not available on all radios.