



Radio Face Quick Start Guide

DIN Solutions *Europa*

What's in the Box

Europa Radio Face



Decorative Knob Sets

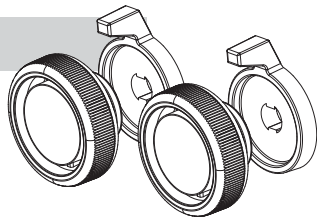

DIN KIT

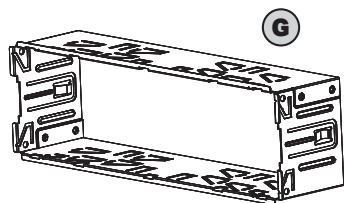
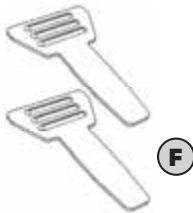
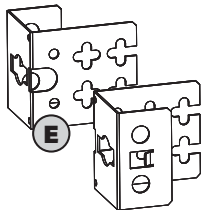

Hardware

A



x(6)



B



Included in your
Radio Motor box
x (8)

RADIO MOTOR IS SHIPPED IN SEPARATE BOX.

Modern Sound For Your Classic

tech@retromanufacturing.com | help.retromanufacturing.com

1

Plug the ribbon cable with a dual bank Molex connector from the Radio Motor into the Radio Face (1a).

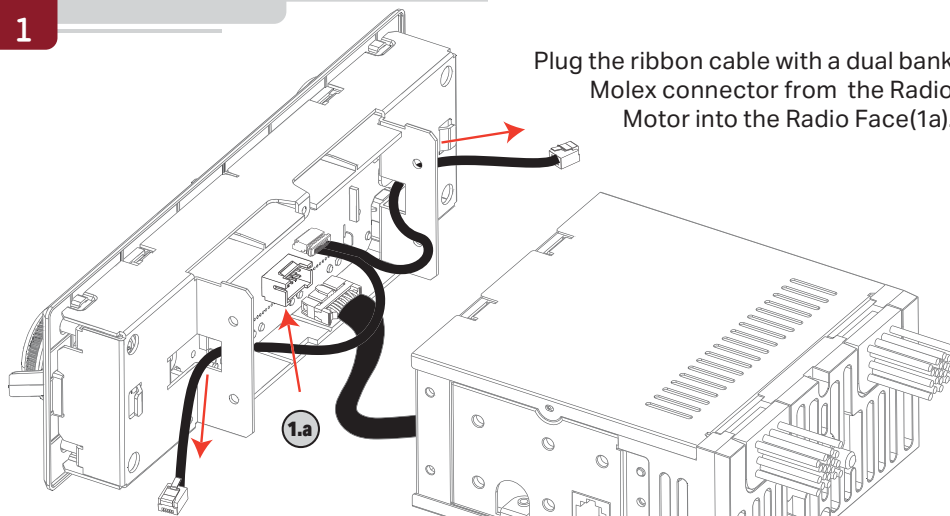

Make sure each end of the Radio Face Y-Connector is routed through the openings in the metal housing of the radio face.

If your **MOTOR INCLUDES A SECOND HARNESS** with a single bank Molex connector, you may remove the Radio Face Y-Harness and attach the second harness from the Motor to the Radio Face in it's place.

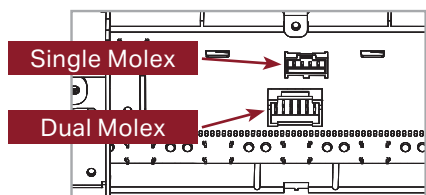

Back of Radio Face

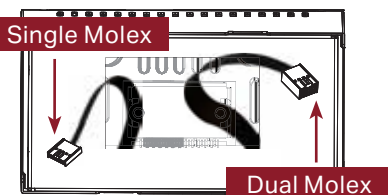

Front of Motor

When connecting with this method, both harnesses from the motor will be used.

2

Attach the Radio Face to the Radio Motor with the four small screws located in the small orange bag (A).

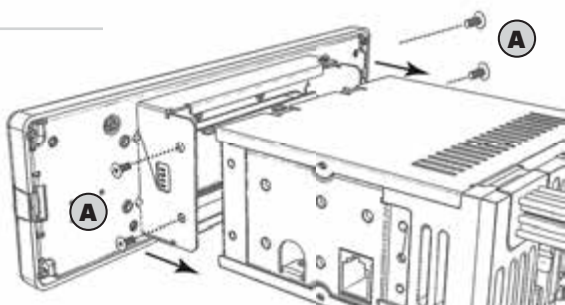

RetroSound®

If using the Radio Face Y-Harness

Before attaching the DIN Brackets, feed the cable from the Radio Face (**3.a**) through the left and right DIN Bracket (**E**).

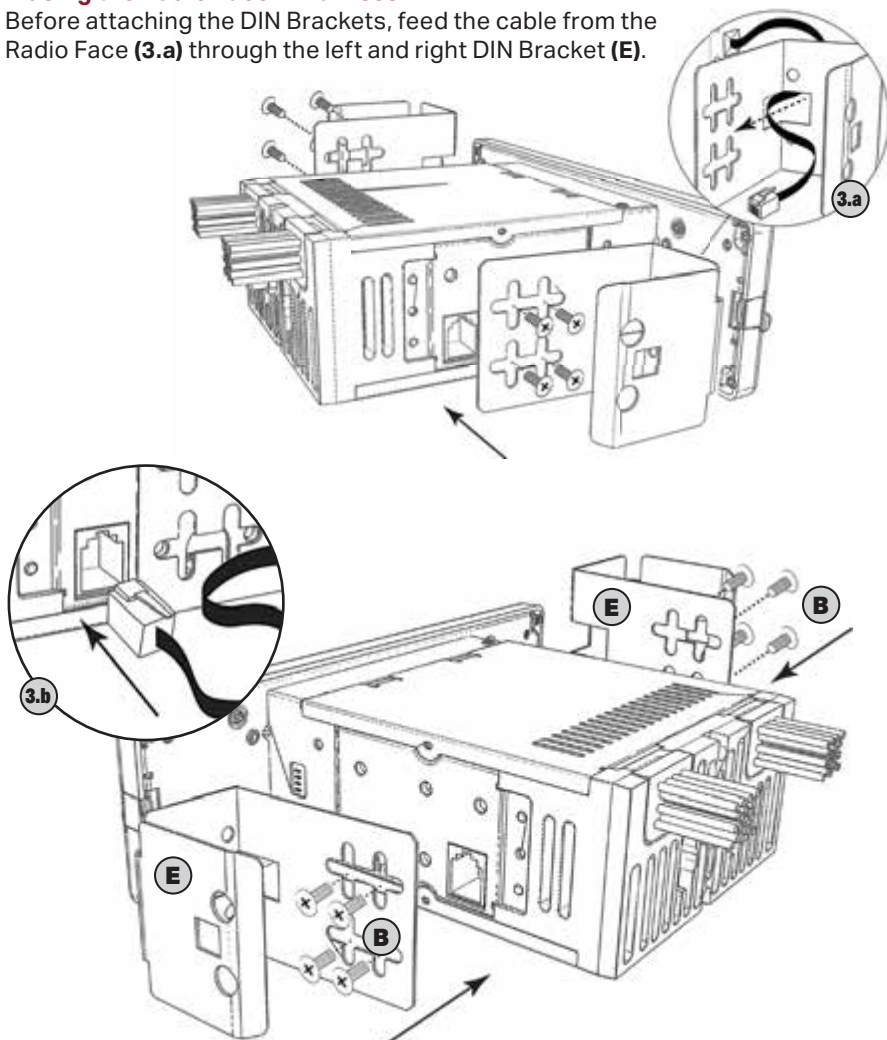

Using the 8 screws (**B**) included in the Radio Motor box, install the DIN Brackets (**E**) to the sides of the Radio Motor. Adjust the brackets forward until they meet the back of the radio face.

Be careful not to bend the brackets to ensure proper fitment into the DIN Sleeve.

If using the Radio Face Y-Harness

Plug the cable from the Radio Face into each side of the Radio Motor (**3.b**).

4

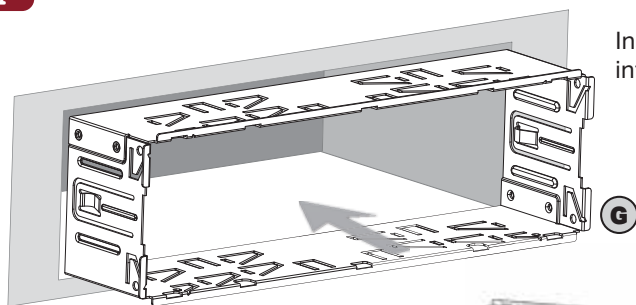

Insert the DIN Sleeve(G) into your dash opening.

Using a screwdriver, push down the sleeve tabs on all four sides of the DIN Sleeve to secure it into the dash opening.

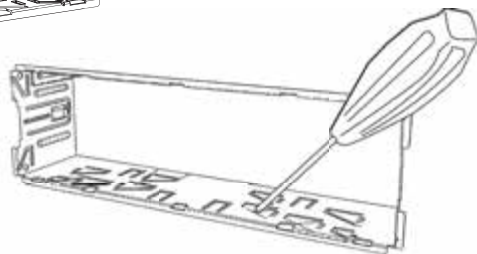

Before moving on to the next step it is advised to refer to the Installation Assembly Manual for DIN Solutions Radios for information on connecting the main wiring harness.

5

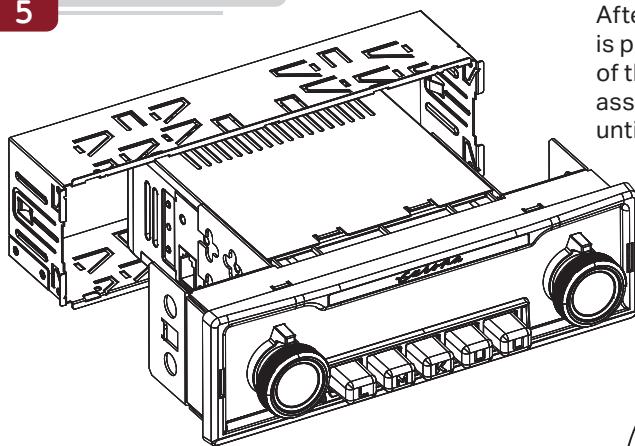

After the main wiring harness is plugged into the back of the radio slide the radio assembly into the DIN Sleeve until the unit clicks into place.

Install one of the included knob sets onto the right and left control shafts.

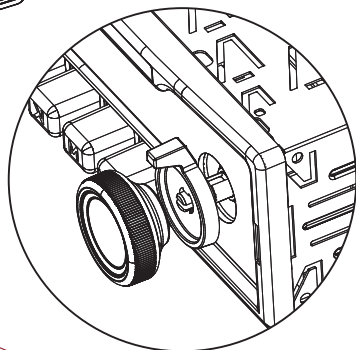

RetroSound®

6

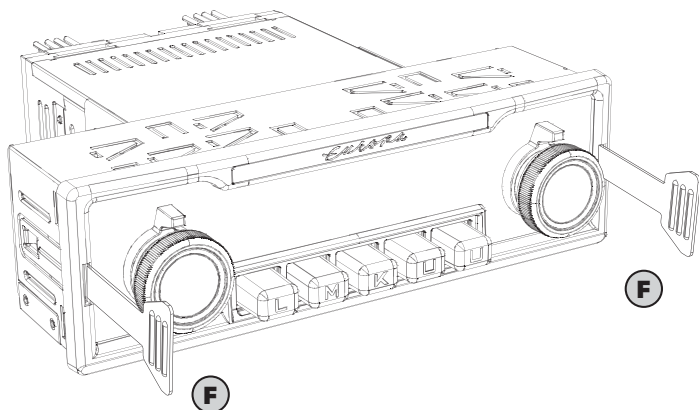

If adjustments are needed, use the included DIN Keys **(F)** to remove the assembly from the DIN Sleeve.

7

Once the Radio is mounted correctly, install the backstrap to the rear of the radio. Follow the installation instructions included with your Radio Motor.

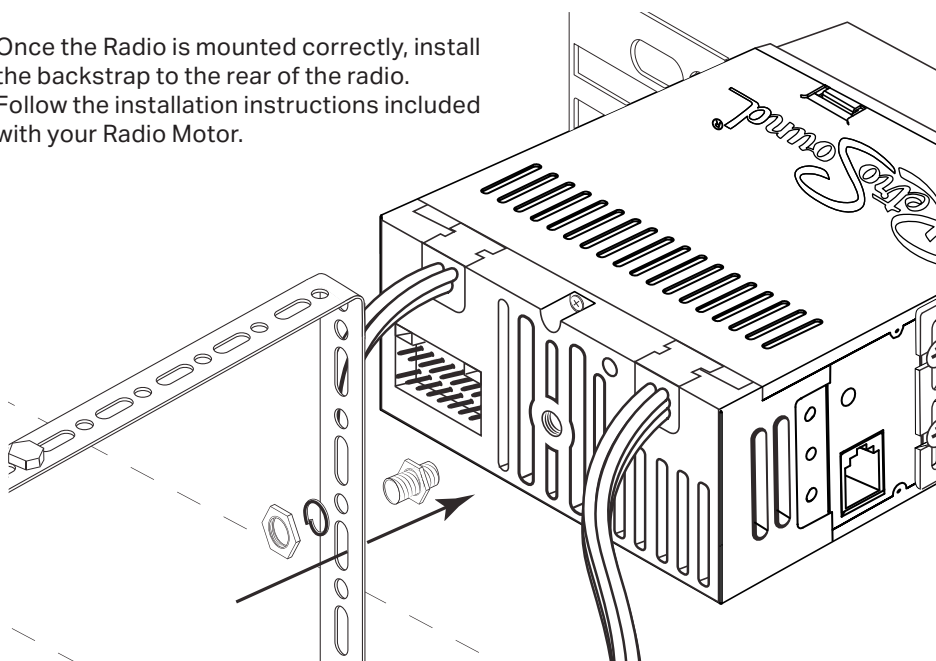

Control Layout

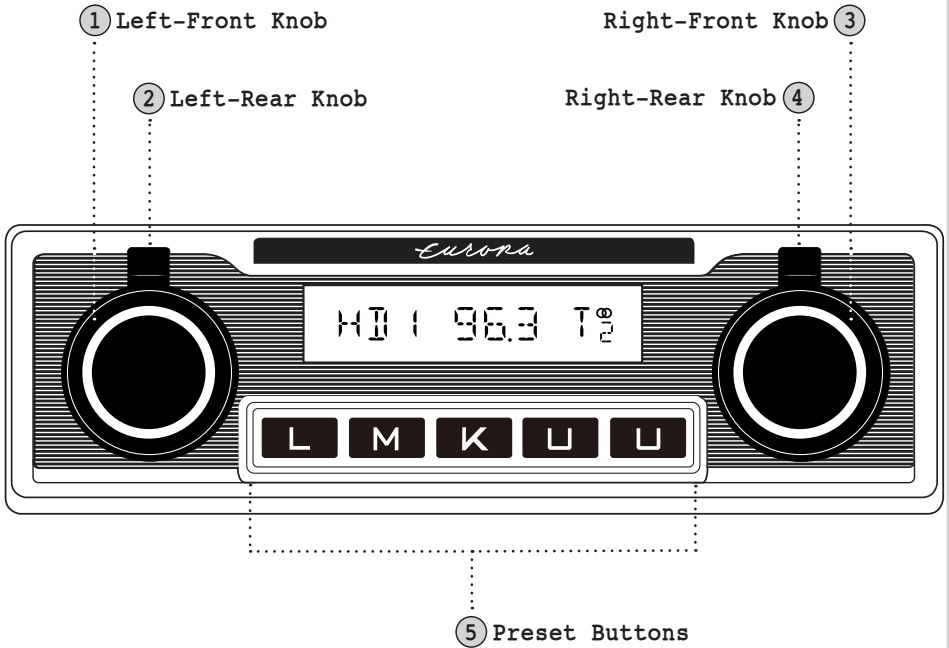

Radio Presets

Setting Radio Presets

To set a preset, tune to the station you want to set the preset to, and then press and hold the desired Preset Button **(5)** for two seconds.

Recalling Radio Presets

To recall a preset, simply press the Preset Button **(5)** your station was set to previously.



Basic Operation

Power On/Off

Press the Left-Front Knob **(1)** to power the unit on.

Press and hold the Left-Front Knob **(1)** to power the unit off.

Volume

Rotate the Left-Front Knob **(1)** to change the volume.

Changing Source Modes

Rotate the Left-Rear Knob **(2)** clockwise to cycle through the source modes.

Changing Radio Bands

Rotate the Right-Rear Knob **(4)** counter-clockwise to cycle through the radio bands.

Tune

Rotate the Right-Front Knob **(3)** to scroll through the stations.

Seek Bar

Press the Seek Bar **(6)** to find the previous/next station, or skip to the previous/next track

Mute On/Off

Press the Right-Front Knob **(3)** to mute and unmute.

Equalizer (EQ)

Press the Left-Front Knob **(1)** to enter the Tone Control sub-menu. Press and release the Left-Front Knob **(1)** until you see the EQ setting you'd like to adjust. Rotate the Left-Front Knob **(1)** to adjust the setting. Press the Left-Front Knob **(1)** to move to the next item, and repeat to adjust each option. Let the unit time out to set.

Setting the Clock

Press and hold the Right-Front Knob **(3)** to enter the System Settings sub-menu. Rotate the Right-Front Knob **(3)** to cycle through the choices until you see CLK, then press the Right-Front Knob **(3)** to select. Rotate the Right-Front Knob **(3)** to adjust the hours. Then press the Right-Front Knob **(3)** again to move on to minutes. Rotate the Right-Front Knob **(3)** to adjust the minutes. Let the unit time out to set.

Display Color*

Press and hold the Right-Front Knob **(3)** to enter the System Settings sub-menu. Rotate the Right-Front Knob **(3)** to cycle through the choices until you see SCAN, then press the Right-Front Knob **(3)** to cycle through the colors. Let the unit time out to set.

Beep On/Off

Press and hold the Right-Front Knob **(3)** to enter the System Settings sub-menu. Rotate the Right-Front Knob **(3)** to cycle through the choices until you see BEEP ON/OFF, then press the Right-Front Knob **(3)** to choose between BEEP ON or BEEP OFF. Let the unit time out to set.

***Some features are not available on all radios.**



7470 Commercial Way,
Henderson, NV 89011
www.retromanufacturing.com